



User Manual

No. MMS-CC-2605-01

NFI Series SSD Impulse Destroyer

NFI-80



– Contents –

1. Safety Precautions P-3
2. Product Specifications P-7
3. Part Identification P-8
4. How to Use the Product P-10
5. Cautions P-12

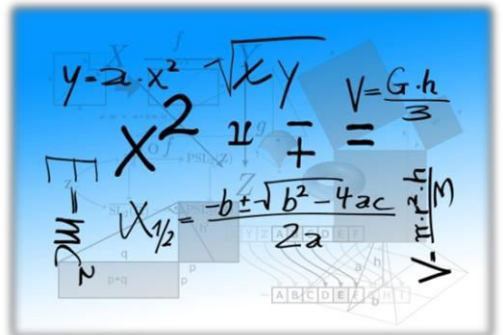





1

Safety Precautions

- ◆ Read this manual thoroughly before use, and use the product safely and correctly.
- ◆ Do not allow anyone unfamiliar with this manual to operate the machine.
- ◆ The cautions shown here contain important safety information – please observe them strictly.

※ These instructions apply commonly to MMS Tech products, so some content may differ from your actual model. Please review the safety precautions in advance.

Icon	Label	Meaning
	WARNING	Failure to follow these instructions may result in death or serious injury.
	CAUTION	Failure to follow these instructions may result in injury or property damage.



WARNING

Do not install in high-humidity locations.

Risk of electric shock. Use within the humidity range specified in this manual.

Maintain at least 15cm of space between the device and walls, and do not place any obstructions.

The internal temperature may rise, and contact may cause burns. It may also cause product malfunction.

Do not install or use for extended periods in tilted or high-vibration locations.
May cause product malfunction or damage.

Avoid prolonged body contact with the surface or vents, of the powered-on product, or with the surface of the connected adapter.

Prolonged exposure may cause red spots, pigmentation, or low-temperature burns.

Do not block the vents on the bottom or sides of the device.
Blocked vents may cause overheating, malfunction, and burns.



WARNING

Do not touch the device or power source with wet hands.
Risk of electric shock

Do not bend the power cable forcefully or allow it to be damaged by heavy objects.
In particular,
keep the cable away from infants and pets to prevent damage.
Damaged cords or cables pose a risk of electric shock or fire.

Verify the operating voltage(single-phase, three-phase) and power capacity.
Electrical work must be performed only by qualified personnel.
Otherwise, electric shock or malfunction may occur.

Disconnect all cables before cleaning the product.
Otherwise, electric shock or malfunction may occur.

Clean internal dust approximately every 6 months.
Static electricity from dust may cause malfunction.



WARNING

Do not place cups of chemicals or water, or other containers on or near the device.
Water entering the product may cause fire or electric shock.

If the device malfunctions or is damaged, turn off the power and contact us for a safety inspection.

Operating a damaged device may cause electric shock or fire.

In enclosed spaces, avoid direct sunlight exposure.

Temperature rise may deform the product, or cause fire.

Keep hands and body away from the motor drive or any pressing equipment.

Risk of fracture or amputation.

Persons with pacemakers must stay clear of the yoke area.

Strong magnetic field exposure may cause pacemaker malfunction.



CAUTION

Avoid using or storing the device in direct sunlight or direct heating/cooling airflow.
This may degrade device performance.

Do not place coffee cups or water containers on the device.

Spilled liquid entering the device may cause electric shock or fire from short circuits.

Avoid using in locations with heavy vibration or significant electrical noise.

This may degrade device performance.

When disconnecting power or communication cables, always grasp the connector.

Pulling on the cord may damage it, causing fire or electric shock.

If water or foreign objects enter the device, turn off the power switch and unplug the power cord.

Continued use may cause electric shock or fire from short circuits.

Do not apply voltage exceeding the specified input rating.

Continued use may cause electric shock or fire.

Do not apply oil or lubricant to the equipment.

May cause malfunction.



CAUTION

Do not clean the device with thinner, benzene, or other volatile solvents.

May degrade device performance.

For cleaning, wipe with a soft dry cloth.

-Pre-Use Cautions-

The contents of this manual may change without prior notice.

Verify that the device matches your ordered specifications.

Verify the operating voltage(single-phase, three-phase) and power capacity. Confirm suitability for the installation site.

Verify the product dimensions and confirm suitability for the installation site.

Do not use this device in the following locations. Such locations may cause malfunction or damage.

- Direct sunlight or near heating equipment, and other high-temperature or high-humidity locations.
(Operating temperature range: 0 ~ 45°C, Operating humidity range: 35 ~ 60%R.H.)
- Locations exposed to sea breeze, corrosive gases, or organic solvent environments.
- Locations with significant dust.
- Locations with significant vibration or shock.
- Locations susceptible to lightning, electric furnaces, surge voltage, or radio interference.

Use in a location where the main unit is not subjected to direct vibration, or shock.

Install the main unit so that it is vertically and horizontally level.

Do not clean the device with alcohol, benzene, or other organic solvents.

Take care not to damage the product when removing packaging.

Avoid locations with strong induction interference, static electricity, or magnetic noise.

When attaching sensors, always turn the power OFF.

If the device does not power on, check the voltage and fuse.

Regular maintenance is recommended for continued safe use of the device.

The warranty period for this device, including accessories is 1 year under normal use.

2

Product Specifications



Model	DEX80
Input Voltage	AC 220V 2A 60Hz
Degaussing Voltage	AC 100V
Weight	approx. 5kg
Dimensions	270 x 250 x 200 mm (W x D x H)

※ Image may differ from the actual product and is subject to change.

3 Part Identification



< Front View >

- ① HMI Monitor
- ② START Switch
- ③ SSD Media Slot
- ④ USB Media Slot

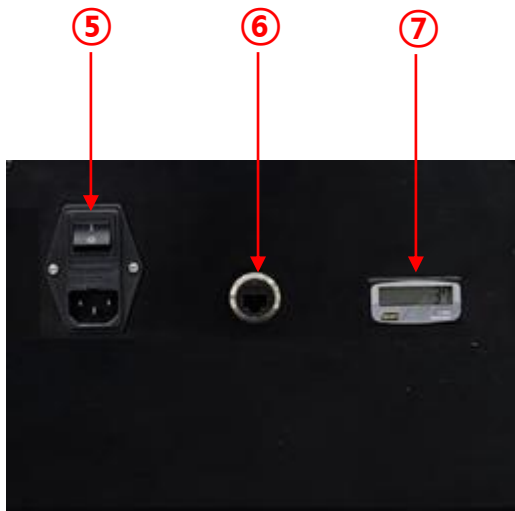

< Rear View >

- ⑤ AC Power
- ⑥ PLC Communication LAN
- ⑦ Counter

* HMI Touch Display Functions

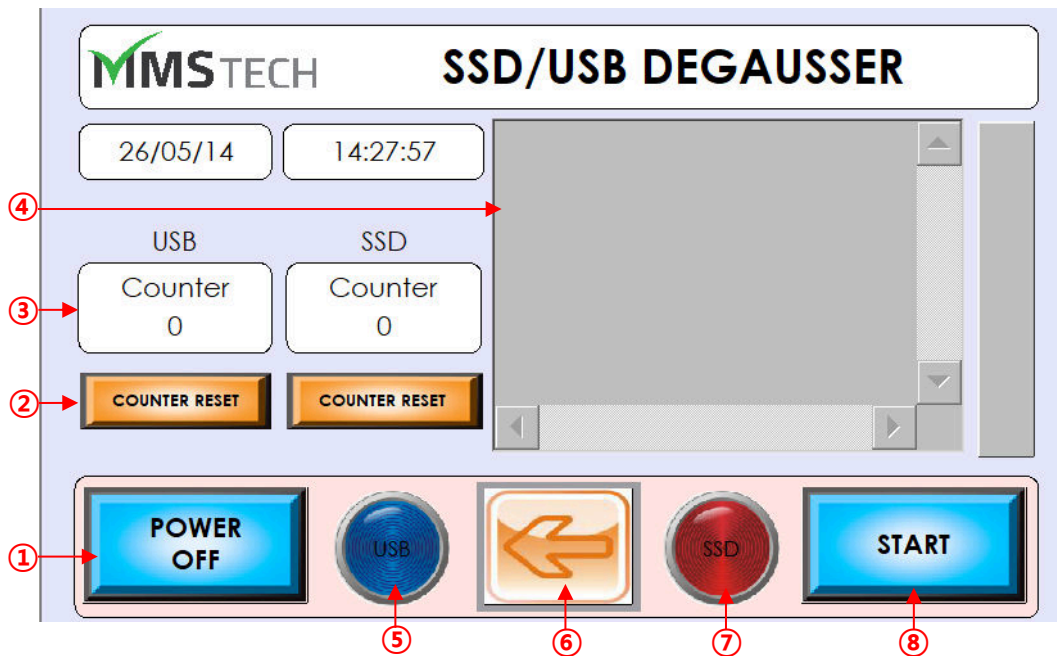

- ① **POWER** : Power ON/OFF
- ② **Counter Reset** : Clear count
- ③ **Counter** : Degaussing total run count
- ④ **Event log** : After each Degaussing cycle, shows record, time, and count
- ⑤ **USB LAMP** : USB media selected — lamp on
- ⑥ **Model Switch** : Data media (USB,SSD) selection switch
- ⑦ **SSD LAMP** : SSD media selected — lamp on
- ⑧ **START**: Degaussing start button



4

How to Use the Degausser



- ① After connecting power to the rear of the product, then press [POWER ON].



- ② Connection Port
Connect the media to be degaussed (SSD or USB) to the port.

※After connection, use the HMI to switch the degaussing media.



- ③ [START] Press the button.
A magnetic field is generated and data is erased.

*** Display Operation Sequence**



※ POWER ON

①

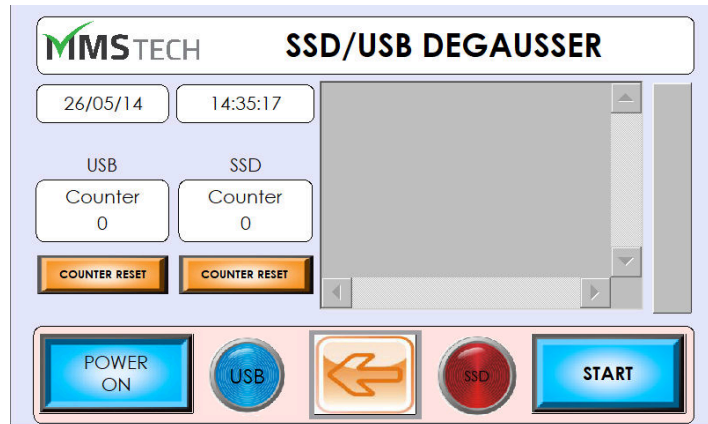

※ Connection Port

②

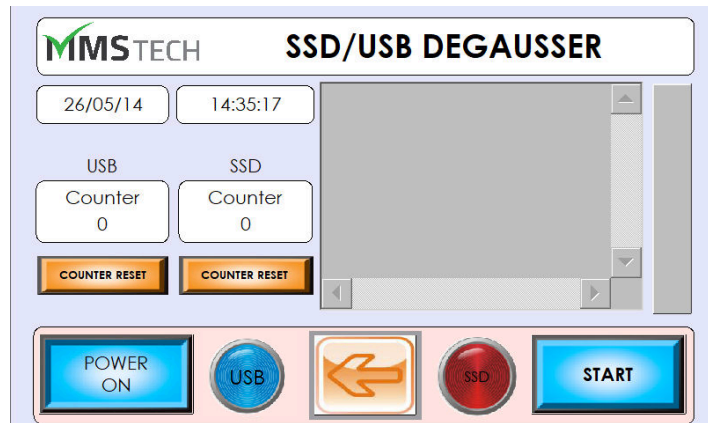

※ START

③

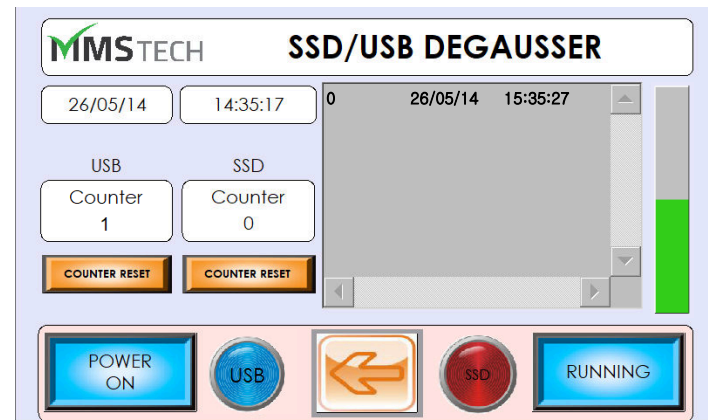



5

Cautions



CAUTION

Persons with pacemakers face risk of malfunction from the strong magnetic field – do not approach the device.

Do not use near flammable or explosive materials.

Do not insert hands or body parts into the slot while the device is operating.

Using power outside the rated voltage may cause product malfunction or fire.

If abnormal noise, odor, or smoke occurs, immediately cut power and stop using the device.

Unauthorized disassembly or modification by the user, may cause product malfunction and may void A/S after-sales service and warranty coverage.

Specifications are subject to change without notice.



U-Reach Data Solutions Inc.
3340 Riverside Dr. Suite C,
Chino, CA 91710
TEL : +1-909-628-7030
Email : sales@ureach-usa.com
Contact : <https://https://ureach-usa.com/>